

AGNIESZKA BUCKA\*

## “A SECOND CHANCE” – THE CONCEPT OF REVITALIZING THE “JAWISZOWICE” STATE COAL MINE

### „DRUGA SZANSA” – KONCEPCJA REWITALIZACJI PAŃSTWOWEJ KOPALNI WĘGLA KAMIENNEGO „JAWISZOWICE”

#### Abstract

The paper presents the problem of degradation of the former industrial complex PKWK “Jawiszowice” in Brzeszcze with its buildings and technical infrastructure, and examines the possibility of its re-use. It emphasizes the benefits of the area revitalization in the broad sense that seems to be the most sensible decision which may be made after the termination of extraction of the raw material. The main aspect is the implementation of innovative and creative solutions which consequently enable the creation of the development not only for the city of Brzeszcze but for the entire region. This example – which is the subject of the present discussion – was also the subject of author’s previous studies conducted in the framework of the masters’ thesis.

*Keywords: revitalization, post-industrial areas, Jawiszowice*

#### Streszczenie

W artykule przedstawiono problem degradacji dawnego kompleksu przemysłowego PKWK<sup>1</sup> „Jawiszowice” w Brzeszczach wraz z jego zabudową i infrastrukturą techniczną, a także rozpatrzono możliwości ponownego ich wykorzystania. Podkreślono korzyści płynące z rozumianej *sensu largo* rewitalizacji obszaru poprzemysłowego, zdającej się być najrozsądniejszą decyzją, jaką można podjąć w związku z zakończeniem eksploatacji surowca. Główny aspekt stanowi wdrożenie innowacyjnych i kreatywnych rozwiązań, które w konsekwencji umożliwią stworzenie przestrzeni rozwoju nie tylko dla miasta Brzeszcze, ale i całego regionu. Przykład będący tematem rozważań jest również przedmiotem wcześniejszych studiów autorki prowadzonych w ramach pracy magisterskiej.

*Słowa kluczowe: rewitalizacja, obszary poprzemysłowe, Jawiszowice*

\* M.Sc. of Architecture Agnieszka Bucka, Department of Civil Engineering and Building Physics, Faculty of Civil Engineering, Cracow University of Technology.

<sup>1</sup> For the purpose of this article I follow K. Lenartowicz terminology [2]: The State Coal Mine Jawiszowice (PKWK Jawiszowice). Originally the complex was called Jawiszowice Mine, while the current name is KWK Brzeszcze Silesia – Ruch II.

## 1. Introduction

### 1.1. Revitalization of post-industrial areas

#### 1.1.1. Western Europe example – “Zollverein” mine in Essen

“Zollverein” mine is one of the most valuable examples of industrial construction. It is worth mentioning that at the time of its heyday, it was the largest and most modern mining facility in the world. The architecture of the complex consists of simple geometric solids, slammed into cubes of steel frame construction, filled with red brick.

In 1986, coal extraction has been suspended [4], and a broad spectrum of social and spatial activities that was later performed, opened a new chapter in the history of the mine. At the moment, the Zollverein industrial complex is a model example of revitalization of post-industrial structures, and is being mentioned alongside such projects as the revival of the steelworks in Duisburg and other industrial Ruhr area. Not without significance is the fact that on 14 December 2001, the group of Zollverein Coal Mine buildings has been inscribed into the UNESCO list of World Heritage under the name “Zollverein Coal Mine Industrial Complex” [3].

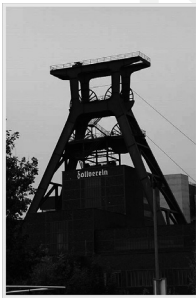

Fig. 1. Mine and coking plant Zollverein in Essen [10]



Fig. 2. Mine and coking plant Zollverein in Essen [10]

#### 1.1.2. An example from Poland – “Julia” mine in Wałbrzych

In 2014, the revitalization of the “Julia” mine in Wałbrzych is to be completed [7], remade – in accordance with the draft zoning made by the *Nizio Design International* studio – into a center of cultural and creative industries, as well as a sports and leisure complex. Designers working on the new look, intend to use large-scale multimedia technologies that have recently been gaining popularity [7].



Fig. 3. “Julia” mine in Wałbrzych – condition of buildings before renovation [9]



Fig. 4. „Julia” mine in Wałbrzych – visualization [8]

## 2. The Idea

### 2.1. PKWK „Jawiszowice” revitalization

#### 2.1.1. History draft

The mining history of the area dates back to the eighteenth century, however, the actual date of facility construction is the beginning of the twentieth century. The establishment of the mine resulted in the rapid growth of Jawiszowice, turning it into a thriving industrial center. Exhaustion of deposits in the 70's was the reason that coal mining became unprofitable. The property was gradually withdrawn from service, and the production was totally discontinued in 1995. In the next years, some of the buildings were sold to private investors, others were demolished, and the rest gradually fell into ruin. The complex has also a rich historical past – during World War II it was a prisoners' labor camp [5]. According to the author of the article, Agnieszka Zaborska-Jagiello [6], some of the PKWK “Jawiszowice” buildings clustered around Andrew III Shaft were included in the provincial register of monuments as a modernist industry building group – but this, in practice, does not necessarily translate into adequate measures to protect the monument.

#### 2.1.2. Main assumptions of revitalization concept

The main idea of revitalization is to transform the industrial area into an educational and cultural center, with the supplement in the form of numerous sports, recreational and entertainment, tourism and museum facilities. The project fits in with the popular in Europe – and tested in the revitalization of other mining objects – trend of so-called “creative industries”, while taking into account the economic and cultural needs of the region. Naming of the buildings has been chosen to combine their old function with the new one, while maintaining the nomenclature proper for the mining industry. For many existing buildings that undergone revitalization and in different zones of the complex, new names have been adopted which evoke the coal exploitation: for example ‘*The Mine of Knowledge*’ (a museum), ‘*The Theatre of Coal-Black Humor*’ (a theater), ‘*SPA-lony Shift*’<sup>2</sup> (a SPA) and ‘*Coal Sketches*’ (an art gallery), ‘*Excavation*’ (a cultural centre), ‘*Extraction*’ (an acting school), ‘*KOKS*’ (the Original Arthouse Cinemas Complex<sup>3</sup>), ‘*The Processing Hall*’ (a school of creative photography), ‘*Tunnel*’ (a school of interior and space design), ‘*Headroom*’ (the management office).

The article describes the general concept of development of the land surface of the mine in the western part of the establishment with its zoning: development, arts, culture, education, museum, sports, shopping, the seat of the administrative staff and complex management, and – in the eastern part – two zones combined: the outdoor and sports area (preserved in the naturalistic style, open-air stage on a hill, an amphitheater and a reservoir equipped with a port for rafts and boats). The mine buildings fit in with the planned large-scale green areas such as forests (the project includes the creation of spaces for undertakings such as a rope course, paintball, quad and cross tracks, skate park, walking paths) and reservoirs (Soła river and ponds created with mining subsidies), which are communicated with each

<sup>2</sup> This name is a wordplay: ‘*spalony*’ in Polish means ‘*burnt*’ (translator’s note).

<sup>3</sup> Also a wordplay: ‘*koks*’ means ‘*coke*’ and is at the same time an acronym for the Polish name of the complex (translator’s note).

other by means of a rollers and bicycle routes and a waterway for boats and rafts. In terms of communication the following are planned: multiple entry points for cars and conveniently located car parks surrounded by protective greenery, a connection of the establishment to the city by a railcar line using existing and unused railroad tracks.

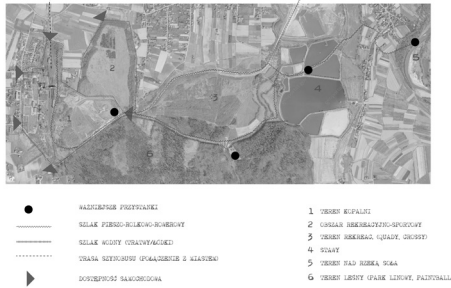

Fig. 5. The environmental analysis of the site PKWK “Jawiszowice” and its surrounding areas (author’s archive)

Fig. 6. The concept of urban revitalization of the PKWK “Jawiszowice” area (author’s archive)



The whole premise closes with the newly designed building of the Art Schools Centre “ARTySZYB” (“ARTySHAFT”). The school in its idea refers to the assumptions of Walter Gropius implemented at the Bauhaus. The name itself combines the former place of work of hundreds of people in the underground of the ‘shafts’ with the newly established buildings of art where, instead of working hard in tough conditions, people are focusing on integration, education, artistic creation and active leisure. It constitutes a denial of the past in relation to the interior form, thanks to wide walking paths, well-lit and vast interiors, the transparency of the newly designed parts of the object, and also to its character: full of vitality. The building is, at the same time, an integral part of both the premises and the greenery (in particular, through the adoption of a green roof), and it consists a contrasting element due to its modern form. It is designed to realize the change that has occurred as a result of the forbearance of its industrial use and of buildings adaptation for educational and artistic functions.

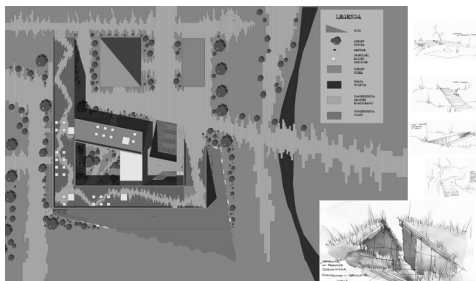

Fig. 7. Art Schools Centre “ARTySZYB” – positioning (author’s archive)

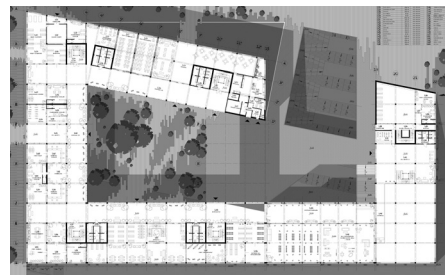

Fig. 8. Centrum Szkół Artystycznych “ARTySZYB” – a groundfloor sketch with its environment (author’s archive)

Using different finishing materials, resulted in a clear difference between the structure of old red brick buildings and a contemporary interference in the form of white-plastered concrete and large glazed surfaces, generating the impression of lightness that stands in opposition to the character of the buildings built in the traditional technology. The main idea of the project is to highlight the antagonisms intensified by the wordplays in the naming and a game of illusion and allusion of two different worlds: the underground – full of gloom and narrowness, accompanying the miners – and the surface, which is reminiscent of light and space.

The entire complex has been designed in such a way as to create a wide range of options to suit the widest possible range of users. The proposed facilities are to counteract the lack of prospects, characteristic for many small towns, and the concepts of proposed functions – to give the possibility to retrain and give employment opportunities to the population that is losing their jobs due to downsizing in the mining industry. For some of the buildings, their features are flexible, giving the possibility to produce income from their usage (renting for purposes such as: events, fairs, workshops, concerts, conferences, sports activities etc.).

### 3. Conclusions

The presented concept meets the problems and issues described by the author (Daria Grochowska) in the article [1], which are: sustainability, accessibility, diversification, open space, compatibility, incentives, adaptability, density and identity of the place. The key role of the revitalization is to optimize the balance of development of the economic and ecological area, with the use of energy-efficient and innovative solutions and technologies that are implemented in the construction of new facilities and the renovation of the existing ones.

Using the unquestionable advantages of the location and the rich history of PKWK 'Jawiszowice', the author tried to transfer western trends to Polish reality, while respecting the cultural values of the region. It is hoped that these studies will be useful in the revitalization works of mines and other objects of this type in Poland.

### References

- [1] Grochowska D., *Nowe życie „miejskich przegranych”: Rewitalizacja kopalni węgla kamiennego „Mysłowice” i terenów przyległych*, czasopismo techniczne, z. 1, 1-A/2012 (rok 109), 200-203.
- [2] Lenartowicz J.K., *Potencjał dziedzictwa techniki w rewitalizacji. Państwowa Kopalnia Węgla Kamiennego Jawiszowice jako ognisko Strategicznej Interwencji w gminie – prolegomena projektu rewitalizacji*, czasopismo techniczne, z. 1-A/2011 (rok 108), 49-58.
- [3] Pasko K., Staszewska-Ludwiczak A., *Przystosowanie wybranych obiektów dziedzictwa przemysłowego na potrzeby bazy hotelarskiej i turystycznej – przykłady z Polski i Europy*, materiały pokonferencyjne z IV Konferencji Naukowo-Praktycznej pt „Dziedzictwo przemysłowe jako strategia rozwoju innowacyjnej gospodarki”, Zabrze 6–7 września 2007, 100.

- [4] Pluta K., *Projektowanie urbanistyczne jako narzędzie kształtowania przestrzeni publicznych w procesie rewitalizacji terenów przemysłowych i kolejowych*, czasopismo techniczne, z. 12, 3-A/2012 (rok 109), 110.
- [5] Senkowska S., *Podobóz Jawiszowicz*, *Odgłosy Brzeszcz*, Nr 9 (141), wrzesień 2003, 14-15.
- [6] Zaborska-Jagiello A., *The state coal mine Jawiszowice in Brzeszcze. The history, present state, architecture, vision of revitalisation with the participation of creative industries*, *AGH Journal of Mining and Geoengineering*, vol. 36, No. 1, 2012, 344.
- [7] [http://architektura.muratorplus.pl/projekty/nowa-inwestycja-w-walbrzychu-rewitalizacja-kopalni-julia\\_80526.html](http://architektura.muratorplus.pl/projekty/nowa-inwestycja-w-walbrzychu-rewitalizacja-kopalni-julia_80526.html) (access: 02.07.2014).
- [8] [http://www.nizio.com.pl/pl/rewitalizacja\\_dawnej\\_kopalni\\_julia\\_w\\_walbrzychu.html](http://www.nizio.com.pl/pl/rewitalizacja_dawnej_kopalni_julia_w_walbrzychu.html) (access: 02.07.2014).
- [9] [http://www.renowacjezabytki.pl/index.php?option=com\\_content&view=article&id=188:rewitalizacja-zabytkowej-kopalni-julia-w-walbrzychu&catid=9](http://www.renowacjezabytki.pl/index.php?option=com_content&view=article&id=188:rewitalizacja-zabytkowej-kopalni-julia-w-walbrzychu&catid=9) (access: 02.07.2014).
- [10] <http://www.zollverein.de> (access: 02.07.2014).

